

V70 (00-08), 2001, D5244T, M56, L.H.D



28/2/2013

PRINT

Contact reel / steering wheel angle sensor, replacing

Preparations

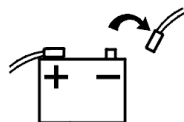

Disconnect the battery lead.
See Battery, disconnecting

Note! As the illustrations in this service information are used for different model years and / or models, some variation may occur. However, the essential information is always correct.

Removing the contact reel

Remove the steering column covers. See Replacing the steering column covers

Remove the steering wheel. See Replacing the steering wheel **(S80/V70/V70XC)** or Steering wheel, replacing **(S60)**.

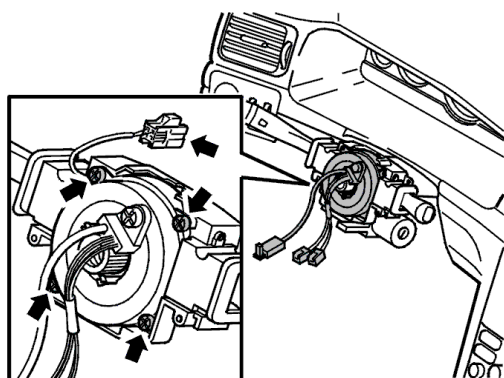

Disconnect the left connector.

Remove:

- the four screws
- the contact reel.

Installing contact reel

Install:

- the contact reel
- the four screws
- the connector.

Zero the contact reel. See Contact reel driver airbag module, resetting .
Install the steering wheel. See Replacing the steering wheel **(S80/V70/V70XC)** or Steering wheel, replacing **(S60)**.
Install the steering column covers. See Replacing the steering column covers .

28/2/2013

PRINT